

Luxembourg-Gasperich – Cessage gasperich Howald

Office space for rent

Property ID: LU881800089_5



Property ID: LU881800089_5 - L-1882 Luxembourg-Gasperich – Cessage gasperich Howald

- At a glance
- The property
- Floor plans
- A first impression
- Contact partner

Property ID: LU881800089_5 - L-1882 Luxembourg-Gasperich – Cessage gasperich Howald

At a glance

| | | | |
|-------------|---------------|-------------|--|
| Property ID | LU881800089_5 | Rent price | On request |
| | | Commission | One month at the expense of the owner. |
| | | Total Space | ca. 13 m ² |

Property ID: LU881800089_5 - L-1882 Luxembourg-Gasperich – Cessage gasperich Howald

Floor plans

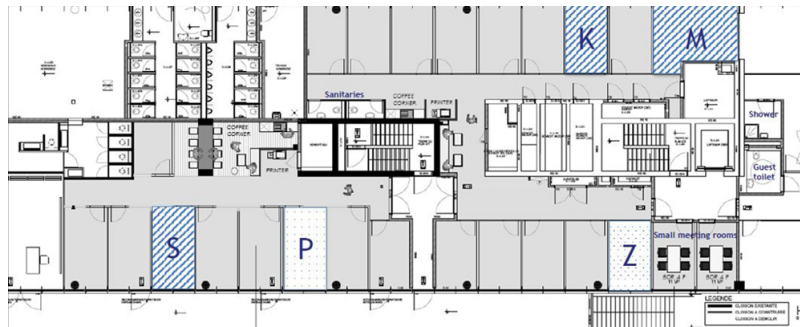

This floor plan is not to scale. The documents were given to us by the client. For this reason, we cannot guarantee the accuracy of the information.

Property ID: LU881800089_5 - L-1882 Luxembourg-Gasperich – Cessage gasperich Howald

A first impression

Beautiful office area fully furnished and equipped. You just have to install and plugger. One part is private and consists of a fully furnished open space and 267 m² shared common area (sanitary, kitchen, informal area, reception and meeting room) 4 parking spaces complete the set. In the same building, a set of closed offices from 13.8 to 19.2 m² are for rent all inclusive.

Property ID: LU881800089_5 - L-1882 Luxembourg-Gasperich – Cessage gasperich Howald

Contact partner

For further information, please contact your contact person:

VON POLL REAL ESTATE Limpertsberg

6, avenue Pasteur, L-2310 Luxembourg

Tel.: +352 26 47 98

E-Mail: limpertsberg@von-poll.com

To Disclaimer of von Poll Immobilien GmbH

www.von-poll.com